

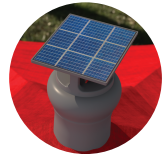

Height Series

Outdoor Smart Umbrella with Wind Sensor, Solar Panel, LED Light, and Remote Control



Solar Panel



Wind Sensor

(Auto Closes Umbrella During High Winds)



LED Light



Remote Control

- * Your umbrella canopy color may differ from image.
- * Umbrella base is not included.

Warranty and Help

One Year Limited Warranty

Questions? We're here to help
Toll Free: **1-888-889-8320**
Email: service@theabove.com

Reflection International Inc.
1502 Foothill Blvd., #103-222
La Verne, CA 91750



Scan here for warranty and replacement parts

Quick Start Guide

1

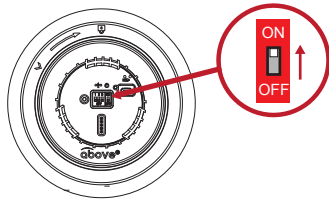

1. Locate the control board at the top of the umbrella.
2. Pull off the silicone cover in the center at the top of the control board.
3. Turn the power switch in the red box from off to on.
4. Push the silicon cover back into place.

2

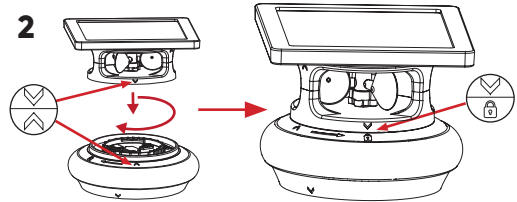

1. Align "∩" on the wind sensor to "∧" on the control board.
2. Turn the wind sensor clockwise until "∩" on the wind sensor is aligned with "⊔" on the control board to lock into place.

Note: The control board is already attached to the top of the umbrella.

3

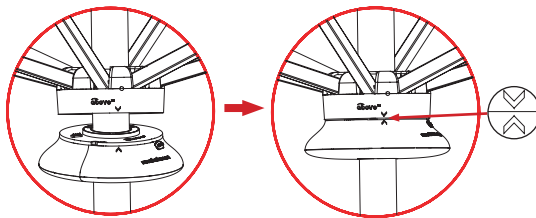

1. Insert the LED Light through the pole with the umbrella. Align "∩" on the lower side, the runner hub with "∧" on the upper side of the LED Light. After aligning the arrows, push them together and they will magnetically snap into place.
(NOTE: "∩" and "∧" must be aligned, otherwise the LED light may not function properly)

4

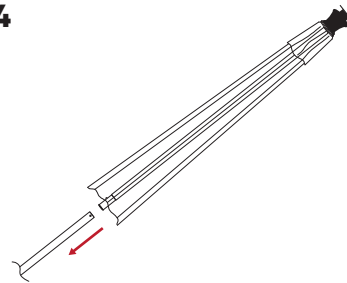

1. Connect the umbrella to the pole provided and secure the umbrella to a base.

Congratulations, your setup is complete!

Quick Tips

Remote Control Functions

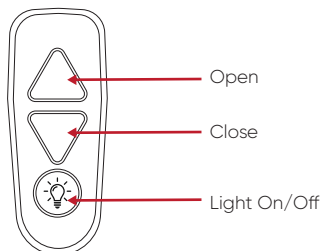

Quick Tips

Your umbrella should come pre-charged. However for the first-time use, it is recommended to charge your umbrella.

1. Charge using Solar

Place the umbrella with the solar panel attached to the control board out in the sun for up to 12 hours for a full charge.

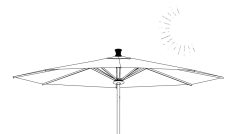

2. Charge Using Micro USB

With the control board attached to the umbrella, charge using the micro USB charging port on the LED light or on top of the control board for up to 4 hours for a full charge.

